



TrackingTheWorld
GPS Tracking Solutions



TrackingTheWorld.com

WT-OBD

**OBD Vehicle
Tracking Device**

USER MANUAL



Document Title	WT-OBD User manual
Version	1.01
Date	2014-03-19
Status	Release
Document Control ID	TTW-WT-OBD-UM001

General Notes

TrackingTheWorld offers this information as a service to its customers, to support application and engineering efforts that use the products designed by TrackingTheWorld. The information provided is based upon requirements specifically provided to TrackingTheWorld by the customers. TrackingTheWorld has not undertaken any independent search for additional relevant information, including any information that may be in the customer's possession. Furthermore, system validation of this product designed by TrackingTheWorld within a larger electronic system remains the responsibility of the customer or the customer's system integrator. All specifications supplied herein are subject to change.

Copyright

This document contains proprietary technical information which is the property of TrackingTheWorld, copying of this document and giving it to others and the using or communication of the contents thereof, are forbidden without express authority. Offenders are liable to the payment of damages. All rights reserved in the event of grant of a patent or the registration of a utility model or design. All specification supplied herein are subject to change without notice at any time.

Copyright © TrackingTheWorld 2016

For More Information: Please contact TrackingTheWorld, 1633 Bayshore Highway, Suite 390, Burlingame, CA. 94010, USA
Phone: +1.650.692.8100 – Email: info@trackingtheworld.com – Website: www.trackingtheworld.com

Copyright © TrackingTheWorld. All rights reserved. Information in this publication supersedes that in all previously published material. Specification and price change privileges reserved. All trade names referenced are the service marks, trademarks, or registered trademarks of their respective companies.

Contents

Contents.....	3
Table Index.....	4
Figure Index	5
0. Revision history	6
1. Introduction.....	7
1.1. Reference.....	7
1.2. Terms and Abbreviations.....	7
2. Product Overview	8
2.1. Description.....	8
2.2. Parts List.....	8
2.3. Interface Definition.....	9
3. Getting Started.....	10
3.1. Opening the Case.....	10
3.2. Closing the Case.....	12
3.3. Installing a SIM Card	13
3.4. Installing the Internal Backup Battery	14
3.5. Device Status LED	14
4. OBD II-related features.....	16
4.1. Communication Protocols	16
4.2. OBD II Parameters	16

For More Information: Please contact TrackingTheWorld, 1633 Bayshore Highway, Suite 390, Burlingame, CA. 94010, USA
Phone: +1.650.692.8100 – Email: info@trackingtheworld.com – Website: www.trackingtheworld.com

Copyright © TrackingTheWorld. All rights reserved. Information in this publication supersedes that in all previously published material. Specification and price change privileges reserved. All trade names referenced are the service marks, trademarks, or registered trademarks of their respective companies.

Table Index

Table 1: WT-OBD Protocol Reference.....	7
Table 2: Terms and Abbreviations	7
Table 3: Part List	8
Table 4: Description of OBD II Connections	9
Table 5: Definition of Device status and LED.....	15
Table 6: Communication Protocols List	16

For More Information: Please contact TrackingTheWorld, 1633 Bayshore Highway, Suite 390, Burlingame, CA. 94010, USA
Phone: +1.650.692.8100 – Email: info@trackingtheworld.com – Website: www.trackingtheworld.com

Copyright © TrackingTheWorld. All rights reserved. Information in this publication supersedes that in all previously published material. Specification and price change privileges reserved. All trade names referenced are the service marks, trademarks, or registered trademarks of their respective companies.

Figure Index

Figure 1.	Appearance of WT-OBD.....	8
Figure 2.	The OBD II connector on the WT-OBD	9
Figure 3.	Opening the Case.....	11
Figure 4.	Closing the Case	12
Figure 5.	SIM Card Installation.....	13
Figure 6.	Backup Battery Installation.....	14
Figure 7.	WT-OBD LED on the Case.....	14

For More Information: Please contact TrackingTheWorld, 1633 Bayshore Highway, Suite 390, Burlingame, CA. 94010, USA
Phone: +1.650.692.8100 – Email: info@trackingtheworld.com – Website: www.trackingtheworld.com

Copyright © TrackingTheWorld. All rights reserved. Information in this publication supersedes that in all previously published material. Specification and price change privileges reserved. All trade names referenced are the service marks, trademarks, or registered trademarks of their respective companies.

0. Revision history

Revision	Date	Author	Description of change
1.00	2013-8-16	Leo LEI	Initial
1.01	2014-03-19	Cid Xu	Updated Introduction information; Updated the pictures; Updated 4.2 OBD II Parameters

For More Information: Please contact TrackingTheWorld, 1633 Bayshore Highway, Suite 390, Burlingame, CA. 94010, USA
Phone: +1.650.692.8100 – Email: info@trackingtheworld.com – Website: www.trackingtheworld.com

Copyright © TrackingTheWorld. All rights reserved. Information in this publication supersedes that in all previously published material. Specification and price change privileges reserved. All trade names referenced are the service marks, trademarks, or registered trademarks of their respective companies.

1. Introduction

The WT-OBD is a vehicle tracking device that plugs into a vehicle's OBD II port. Its compact design allows easy installation. Its internal OBD reader can obtain information from the vehicle's on-board computer and relay it over GPRS networks. Its built in GPS receiver has superior sensitivity and fast time to first fix. Its quad band GPRS/GSM subsystem supports 850/900/1800/1900 MHz allowing the WT-OBD's location to be monitored in real time or periodically tracked by a backend server and mobile devices. Its built in 3-axis accelerometer allows motion detection and extended backup battery life through sophisticated power management algorithms. System integration is straightforward as complete documentation is provided for the full featured @Track protocol. The @Track protocol supports a wide variety of reports including; emergency, geo-fence boundary crossings, driver behaviour, low battery or scheduled GPS position and many other useful functions.

1.1. Reference

Table 1: WT-OBD Protocol Reference

SN	Document name	Remark
[1]	WT-OBD @Track Air Interface Protocol	The air protocol interface between WT-OBD and backend server.

1.2. Terms and Abbreviations

Table 2: Terms and Abbreviations

Abbreviation	Description
PWR	External Power Supply
GND	Ground
OBD	On-Board Diagnostics
SAE	Society of Automotive Engineers

For More Information: Please contact TrackingTheWorld, 1633 Bayshore Highway, Suite 390, Burlingame, CA. 94010, USA
Phone: +1.650.692.8100 – Email: info@trackingtheworld.com – Website: www.trackingtheworld.com

Copyright © TrackingTheWorld. All rights reserved. Information in this publication supersedes that in all previously published material. Specification and price change privileges reserved. All trade names referenced are the service marks, trademarks, or registered trademarks of their respective companies.

2. Product Overview

2.1. Description

WT-OBD is based on the OBD II interface GPS vehicle tracking device, compact design and easy to install. WT-OBD contains an OBD II connector which complies with J1962 standard, a 10PIN USB connector, an internal GSM antenna, an internal GPS antenna and three LEDs.



Figure 1. Appearance of WT-OBD

2.2. Parts List

Table 3: Part List

Name	Picture
WT-OBD Locator	48mm*25mm*48mm
DATA_CABLE_M (Optional)	

For More Information: Please contact TrackingTheWorld, 1633 Bayshore Highway, Suite 390, Burlingame, CA. 94010, USA
Phone: +1.650.692.8100 – Email: info@trackingtheworld.com – Website: www.trackingtheworld.com

Copyright © TrackingTheWorld. All rights reserved. Information in this publication supersedes that in all previously published material. Specification and price change privileges reserved. All trade names referenced are the service marks, trademarks, or registered trademarks of their respective companies.

2.3. Interface Definition

The WT-OBD has an OBD II connector. It contains power supply and interfaces of CAN bus, K-line, L-line and J1850 bus. The sequence and definition of the OBD II connector are shown in following figure:



Figure 2. The OBD II connector on the WT-OBD

Table 4: Description of OBD II Connections

Index	Description	Comment
1	PWR	External DC power input, 8-32V
2	L-line	L line of ISO 9141-2 and ISO 14230-4
3	CAN-L	CAN-L line of ISO 15765-4
4	J1850-	Bus negative line of SAE J1850
5	K-line	K line of ISO 9141-2 and ISO 14230-4
6	CAN-H	CAN-H line of ISO 15765-4
7	GND	Power and digital ground
8	GND	Power and digital ground
9	J1850+	Bus positive line of SAE J1850

For More Information: Please contact TrackingTheWorld, 1633 Bayshore Highway, Suite 390, Burlingame, CA. 94010, USA
 Phone: +1.650.692.8100 – Email: info@trackingtheworld.com – Website: www.trackingtheworld.com

Copyright © TrackingTheWorld. All rights reserved. Information in this publication supersedes that in all previously published material. Specification and price change privileges reserved. All trade names referenced are the service marks, trademarks, or registered trademarks of their respective companies.

3. Getting Started

3.1. Opening the Case

Insert the triangular-pry-opener into the gap of the case as shown below, push the opener up until the case unsnapped.



For More Information: Please contact TrackingTheWorld, 1633 Bayshore Highway, Suite 390, Burlingame, CA. 94010, USA
Phone: +1.650.692.8100 – Email: info@trackingtheworld.com – Website: www.trackingtheworld.com

Copyright © TrackingTheWorld. All rights reserved. Information in this publication supersedes that in all previously published material. Specification and price change privileges reserved. All trade names referenced are the service marks, trademarks, or registered trademarks of their respective companies.



Figure 3. Opening the Case

For More Information: Please contact TrackingTheWorld, 1633 Bayshore Highway, Suite 390, Burlingame, CA. 94010, USA
Phone: +1.650.692.8100 – Email: info@trackingtheworld.com – Website: www.trackingtheworld.com

Copyright © TrackingTheWorld. All rights reserved. Information in this publication supersedes that in all previously published material. Specification and price change privileges reserved. All trade names referenced are the service marks, trademarks, or registered trademarks of their respective companies.

3.2. Closing the Case

The battery is glued to top cover, so before closing the case you should let the battery connector plugged in. The step of closing case is shown as following:

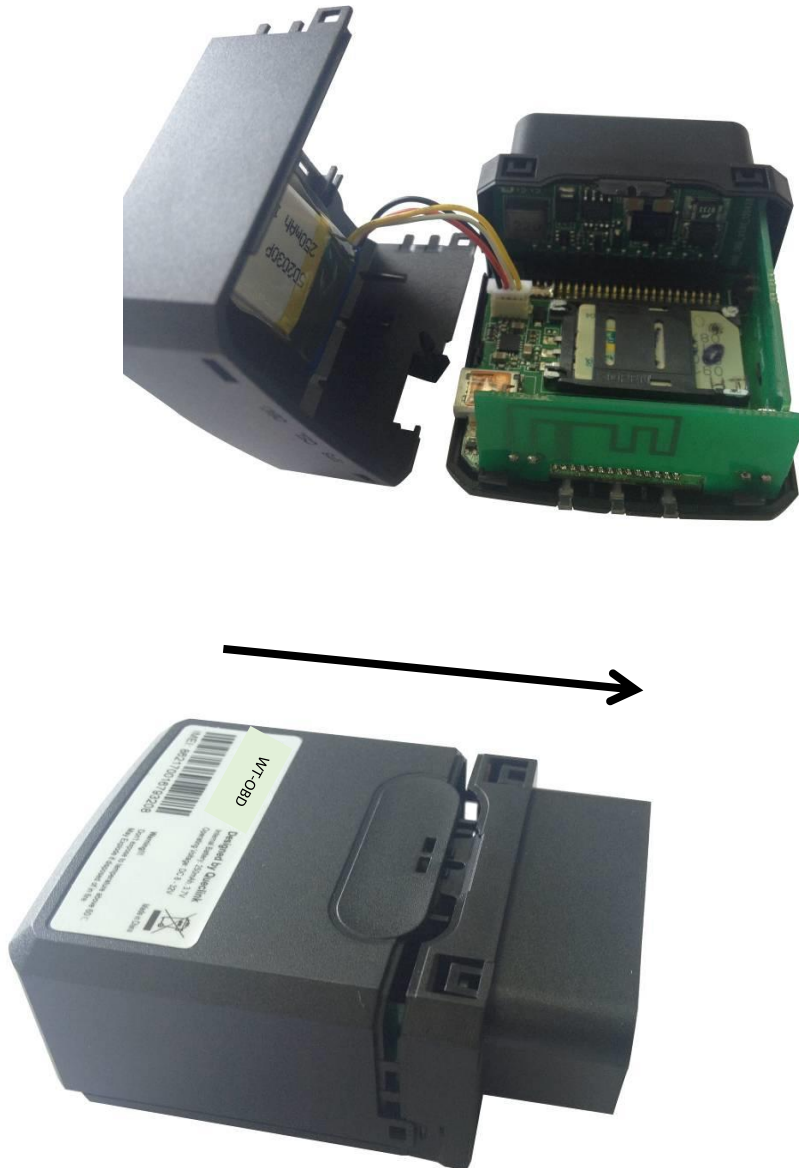

Figure 4. Closing the Case

For More Information: Please contact TrackingTheWorld, 1633 Bayshore Highway, Suite 390, Burlingame, CA. 94010, USA
Phone: +1.650.692.8100 – Email: info@trackingtheworld.com – Website: www.trackingtheworld.com

Copyright © TrackingTheWorld. All rights reserved. Information in this publication supersedes that in all previously published material. Specification and price change privileges reserved. All trade names referenced are the service marks, trademarks, or registered trademarks of their respective companies.

3.3. Installing a SIM Card

Open the case and ensure the unit is not powered. Slide the holder right to open the SIM card. Insert the SIM card into the holder as shown below with the gold-colored contact area facing down taking care to align the cut mark. Close the SIM card holder. Close the case.

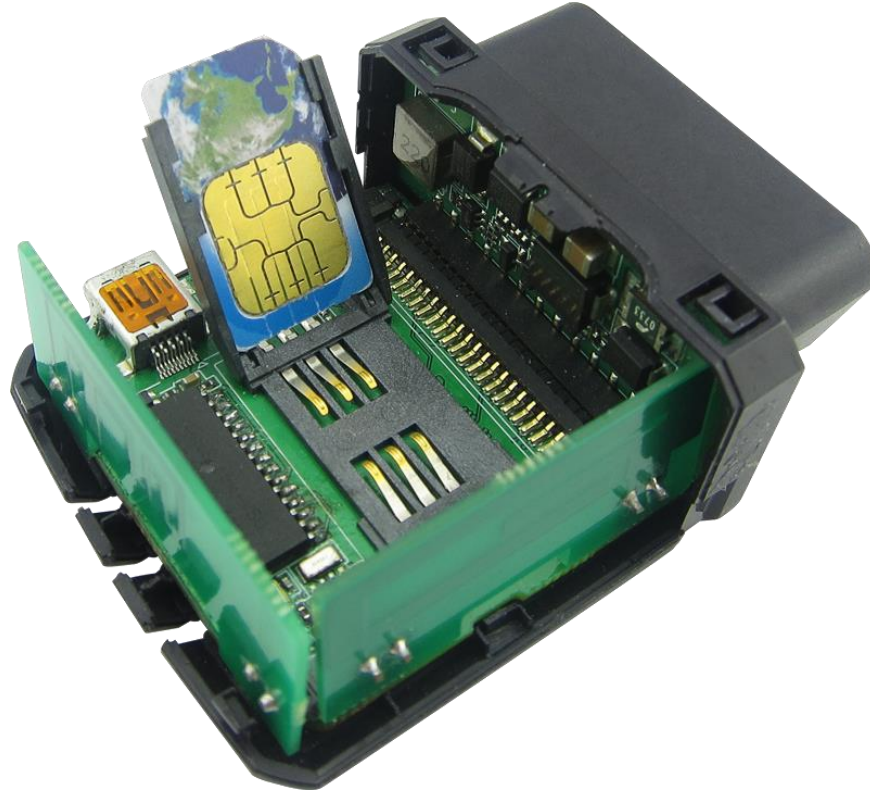

Figure 5. SIM Card Installation

For More Information: Please contact TrackingTheWorld, 1633 Bayshore Highway, Suite 390, Burlingame, CA. 94010, USA
Phone: +1.650.692.8100 – Email: info@trackingtheworld.com – Website: www.trackingtheworld.com

Copyright © TrackingTheWorld. All rights reserved. Information in this publication supersedes that in all previously published material. Specification and price change privileges reserved. All trade names referenced are the service marks, trademarks, or registered trademarks of their respective companies.

3.4. Installing the Internal Backup Battery



Figure 6. Backup Battery Installation

There is an internal backup Li-ion battery.

3.5. Device Status LED



Figure 7. WT-OBD LED on the Case

For More Information: Please contact TrackingTheWorld, 1633 Bayshore Highway, Suite 390, Burlingame, CA. 94010, USA
Phone: +1.650.692.8100 – Email: info@trackingtheworld.com – Website: www.trackingtheworld.com

Copyright © TrackingTheWorld. All rights reserved. Information in this publication supersedes that in all previously published material. Specification and price change privileges reserved. All trade names referenced are the service marks, trademarks, or registered trademarks of their respective companies.

Table 5: Definition of Device status and LED

LED	Device status	LED status
CEL (note1)	Device is searching GSM network	Fast flashing (Note3)
	Device has registered to GSM network.	Slow flashing (Note4)
	SIM card needs pin code to unlock.	ON
GPS (note 2)	GPS chip is powered off	OFF
	GPS sends no data or data format error.	Slow flashing
	GPS chip is searching GPS info.	Fast flashing
	GPS chip has gotten GPS info.	ON
OBD (note 2)	No external power and internal battery voltage is lower than 3.46V. WT-OBD is power off.	OFF
	No external power and internal battery voltage is below 3.55V	Slow flashing
	External power in and internal battery is charging	Fast flashing
	External power in and internal battery is fully charged	ON

Note:

- 1 - CEL LED cannot be configured.
- 2 - GPS LED and OBD LED can be configured to turn off after a period of time using the configuration tool
- 3 - Fast flashing is about 60ms ON/ 780ms OFF
- 4 - Slow flashing is about 60ms ON/ 1940ms OFF

For More Information: Please contact TrackingTheWorld, 1633 Bayshore Highway, Suite 390, Burlingame, CA. 94010, USA
 Phone: +1.650.692.8100 – Email: info@trackingtheworld.com – Website: www.trackingtheworld.com

Copyright © TrackingTheWorld. All rights reserved. Information in this publication supersedes that in all previously published material. Specification and price change privileges reserved. All trade names referenced are the service marks, trademarks, or registered trademarks of their respective companies.

4. OBD II-related features

4.1. Communication Protocols

WT-OBD could monitor the OBD II system via not only communication protocols which defined by SAE but also some special protocols. The list of protocols is shown as follow:

Table 6: Communication Protocols List

No.	Protocol	Comment
1	J1850 PWM	41.6kb/s FORD
2	J1850 VPW	10.4kb/s GM/Chrysler
3	ISO 9141-2	5 Baud init automatic baud rate
4	ISO 14230	5 Baud init 10.4kb/s
5	ISO 14230	Fast init 10.4kb/s
6	ISO 15765	ID 11bits 500kb
7	ISO 15765	ID 29bits 500kb
8	ISO 15765	ID 11bits 250kb
9	ISO 15765	ID 29bits 250kb
10	J1939	ID 29bit 250kb
11	CAN_USER1	11*bits 125*kb
12	CAN_USER2	11*bits 50*kb
13	VW TP2.0	Volkswagen CAN protocol

4.2. OBD II Parameters

WT-OBD can read the following parameters through OBD II system.

- 1) Vehicle identification number (VIN):
- 2) OBD Power Voltage
- 3) Parameter identification (PID)
- 4) Revolutions per minute of the engine (RPM)
- 5) Vehicle speed
- 6) Engine Coolant Temperature
- 7) Fuel Consumption
- 8) Distance Statistics
- 9) Malfunction Indicator Lamp (MIL)
- 10) Diagnostic Trouble Codes (DTC)
- 11) Throttle Position
- 12) Engine Load
- 13) Fuel Level Input

For More Information: Please contact TrackingTheWorld, 1633 Bayshore Highway, Suite 390, Burlingame, CA. 94010, USA
Phone: +1.650.692.8100 – Email: info@trackingtheworld.com – Website: www.trackingtheworld.com

Copyright © TrackingTheWorld. All rights reserved. Information in this publication supersedes that in all previously published material. Specification and price change privileges reserved. All trade names referenced are the service marks, trademarks, or registered trademarks of their respective companies.

Note:

1 - The VIN is the unique identifier of Vehicle. Please note that not all Vehicle support getting the VIN from OBD II system, because the Vehicle manufacturers are responsible for defining the data return from OBD II system.

2 - Distance Statistics: WT-OBD could get the distance in two cases: distance accumulated since MIL is activated and distance accumulated since DTCs were cleared.

For More Information: Please contact TrackingTheWorld, 1633 Bayshore Highway, Suite 390, Burlingame, CA. 94010, USA
Phone: +1.650.692.8100 – Email: info@trackingtheworld.com – Website: www.trackingtheworld.com

Copyright © TrackingTheWorld. All rights reserved. Information in this publication supersedes that in all previously published material. Specification and price change privileges reserved. All trade names referenced are the service marks, trademarks, or registered trademarks of their respective companies.